

BAY STAR SPORT & BAY STAR

2016 GAS MOTOR COACHES



WHEN YOU KNOW THE DIFFERENCE SM



MATT UTLEY
VP of Service Operations

“As a member of the Newmar service team for the past 20 years, I am committed to using honesty and respect to establish meaningful relationships with our customers. As the owner of a new Bay Star Sport or Bay Star, you’re a part of the Newmar family. And we want you to know that should you ever have a problem or concern, we’re here to help 24/7. Our goal is to provide you with what we call “Seamless Service,” and I am confident you will find the support you receive to be refreshing and exemplary.”





BAY STAR SPORT

BEHOLD THE
NEWMAR DIFFERENCE

Full-Paint exterior graphic treatment with
Clear Coat finish

Available triple-slide floor plan with full-wall
slide-out and bunk beds

Reimagined interior with solid surfaces throughout

Custom-tuned 4-speaker JBL® premium cockpit
audio system



WHEN YOU KNOW THE DIFFERENCE SM

AN EXTRA HELPING OF AMENITIES

Presenting a kitchen that caters to your every need. Solid-surface countertops – complete with a handy pull-out counter* – are surrounded by stylish cabinetry and a beautiful brick-patterned backsplash. Added versatility comes in the form of a multi-functional dinette that can be stored and used as a seating area, while a roomy pantry helps you store all of your kitchen supplies.

**Pull-out counter included with floor plan 3004*



Refrigerator with Pantry





Fossil Interior Décor and Astoria Glazed Maple Cabinetry – Floor Plan 3004



72" Bunk Beds – Floor Plan 3004

THE ONE FOR ALL

New for 2016, floor plan 3004 outfits Bay Star Sport with bunk beds for the very first time. Children and adults alike can sleep soundly on a pair of lengthy 72" mattresses located inside of a full-wall slide.

Each bunk space features its own private reading light and provides occupants with a set of drawers and individual windows. An optional folding Hide-a-Bed sofa adds incredible versatility, the kind that lets you enjoy some quality rest and relaxation before providing your guests with a comfortable place to spend the night.



Optional Folding Hide-a-Bed Sofa

RELAX AND RESTORE

The perfect restful respite, Bay Star Sport's master bedroom welcomes you with a full queen bed, plush pillows and stitched headboard. Virtually everything in sight – from the dressers to the ultra-accommodating wardrobe – features Newmar's gorgeous new Astoria Maple wood finish.

Accented by fresh new fabrics and brushed nickel hardware on all drawers, you'll feel right at home no matter how far you travel. You can even enjoy crystal clear picture and sound without disturbing the rest of your passengers thanks to an optional LED TV that can be shielded from the rest of the coach.

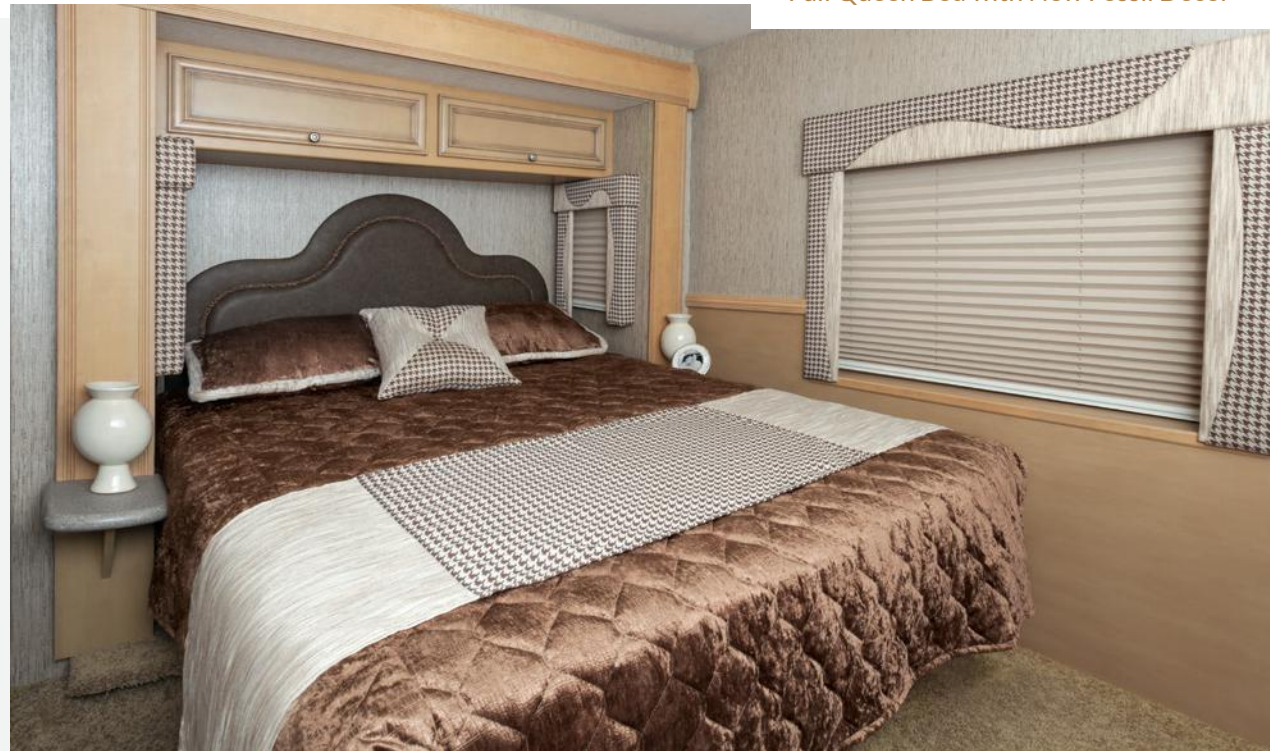

Dual-Vanity Wardrobe with Brushed Nickel Hardware

ANYTHING BUT BASIC

While the bathrooms inside many gas-powered coaches leave much to be desired, the 2016 Bay Star Sport greets you with a solid-surface vanity that encompasses an all-new stainless steel sink. An overhead skylight bathes you in sunlight from the moment you step inside the shower. What's more, storage is everywhere you look, including the newly raised base cabinet and hallway linen closet.



Spacious Storage Cabinets





EXTERIOR DÉCOR



IMPRESSION EXTERIOR

INTERIOR DÉCOR

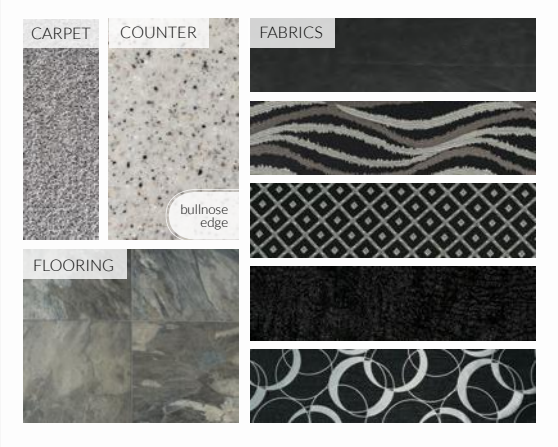

ANTHRACITE INTERIOR



FOSSIL INTERIOR

WOOD OPTIONS



CARBON EXTERIOR



ASTORIA GLAZED
MAPLE



SIENNA GLAZED
MAPLE



EMPIRE GLAZED
MAPLE

BAY STAR SPORT

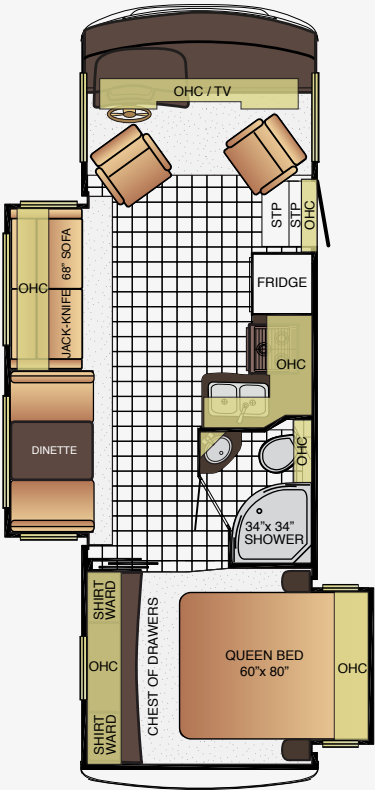

2702

| | |
|---------------------|------------|
| App. Overall Length | 27'9" |
| Width | 101.5" |
| App. Overall Height | 12'4" |
| Interior Width | 95.5" |
| Interior Height | 80" |
| Grey Tank | 60 gal. |
| Sewage Tank | 40 gal. |
| Water Tank | 75 gal. |
| Propane Tank | 25 gal. |
| Furnace | 30,000 btu |

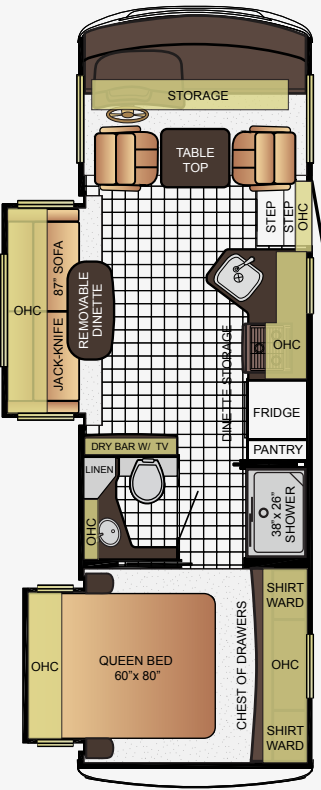

2705

| | |
|---------------------|------------|
| App. Overall Length | 27'11" |
| Width | 101.5" |
| App. Overall Height | 12'4" |
| Interior Width | 95.5" |
| Interior Height | 80" |
| Grey Tank | 60 gal. |
| Sewage Tank | 40 gal. |
| Water Tank | 75 gal. |
| Propane Tank | 25 gal. |
| Furnace | 30,000 btu |

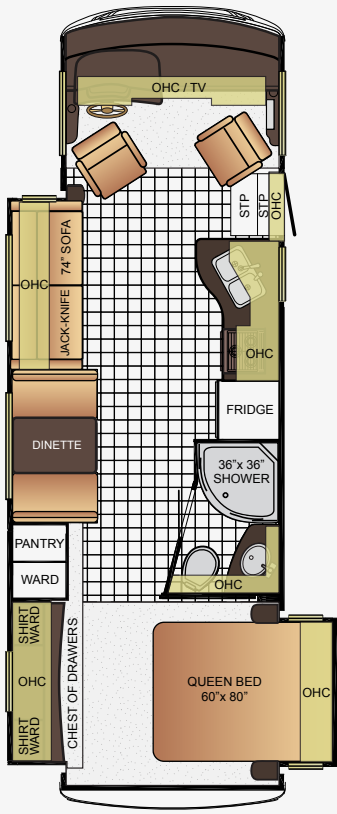

FLOOR PLANS

2903

| | |
|---------------------|------------|
| App. Overall Length | 29'11" |
| Width | 101.5" |
| App. Overall Height | 12'4" |
| Interior Width | 95.5" |
| Interior Height | 80" |
| Grey Tank | 60 gal. |
| Sewage Tank | 40 gal. |
| Water Tank | 75 gal. |
| Propane Tank | 25 gal. |
| Furnace | 30,000 btu |

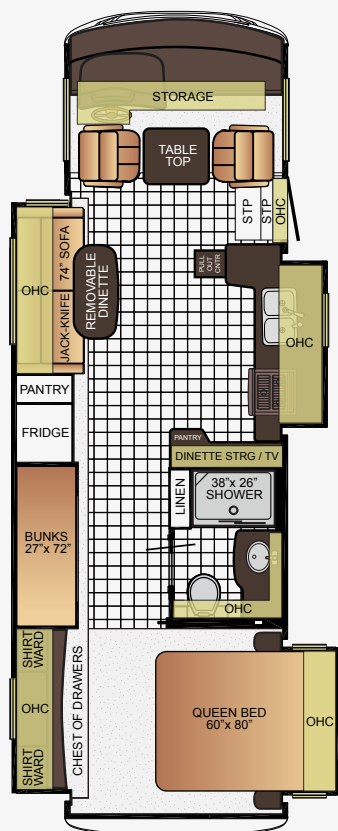

3004

| | |
|---------------------|------------|
| App. Overall Length | 30'11" |
| Width | 101.5" |
| App. Overall Height | 12'4" |
| Interior Width | 95.5" |
| Interior Height | 80" |
| Grey Tank | 60 gal. |
| Sewage Tank | 40 gal. |
| Water Tank | 75 gal. |
| Propane Tank | 25 gal. |
| Furnace | 30,000 btu |

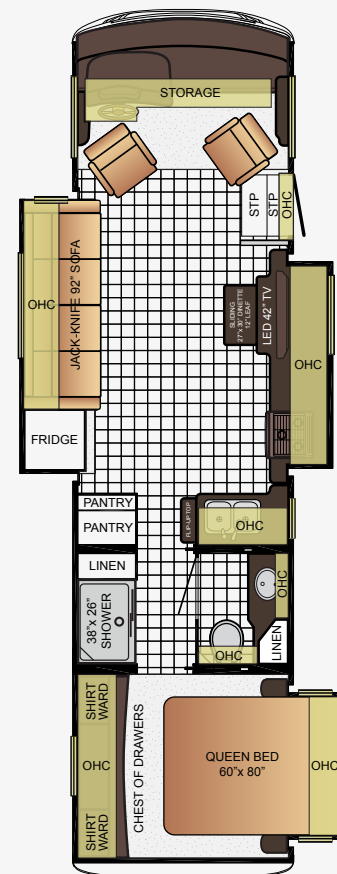

3227

| | |
|---------------------|------------|
| App. Overall Length | 32'11" |
| Width | 101.5" |
| App. Overall Height | 12'4" |
| Interior Width | 95.5" |
| Interior Height | 80" |
| Grey Tank | 60 gal. |
| Sewage Tank | 40 gal. |
| Water Tank | 75 gal. |
| Propane Tank | 25 gal. |
| Furnace | 30,000 btu |

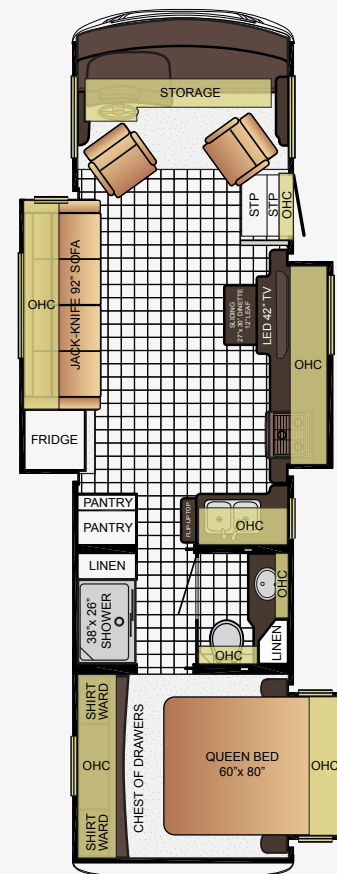

FLOOR PLANS

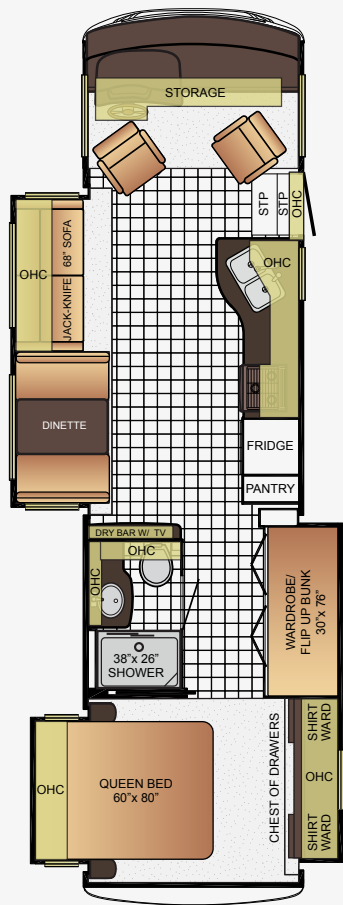

3306

| | |
|---------------------|------------|
| App. Overall Length | 33'11" |
| Width | 101.5" |
| App. Overall Height | 12'4" |
| Interior Width | 95.5" |
| Interior Height | 80" |
| Grey Tank | 60 gal. |
| Sewage Tank | 40 gal. |
| Water Tank | 75 gal. |
| Propane Tank | 25 gal. |
| Furnace | 30,000 btu |

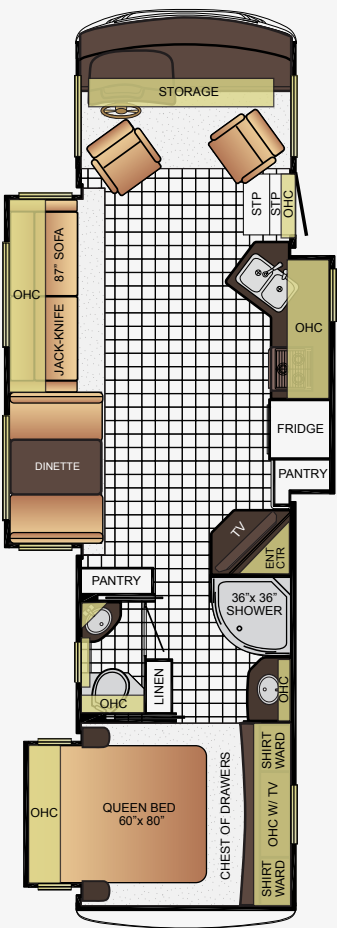

3404

| | |
|---------------------|------------|
| App. Overall Length | 34'11" |
| Width | 101.5" |
| App. Overall Height | 12'4" |
| Interior Width | 95.5" |
| Interior Height | 80" |
| Grey Tank | 60 gal. |
| Sewage Tank | 40 gal. |
| Water Tank | 75 gal. |
| Propane Tank | 25 gal. |
| Furnace | 35,000 btu |

BAY STAR SPORT CONSTRUCTION & CHASSIS SPECIFICATIONS

Like a fine home, the 2016 Bay Star Sport gas motor coach is framed 16 inches on center, allowing the best placement of outlets, switches and other components. Newmar uses only Sikaflex® elastic adhesive throughout Bay Star Sport's construction – one of the strongest bonding agents available. It seals against

air and water and helps dampen sound and vibration. Electrical wiring holes in Bay Star Sport's aluminum frame are ringed with plastic grommets to protect wires from chafing. And Newmar's Total Comfort™ Central Air is two separate, fully-ducted systems that distribute cool air and remove warm air.

| Floor Plan | Engine HP | Axle Ratio | Fuel Cap. | Wheel Base | Front GAWR* | Rear GAWR* | GVWR* | GCWR* | App. UVW | App. NCC |
|------------|-----------|------------|-----------|------------|-------------|------------|------------|------------|------------|-----------|
| 2702 | 362 | 4.88 | 80 gal. | 172 | 7,000 lb. | 12,000 lb. | 18,000 lb. | 23,000 lb. | 15,322 lb. | 2,678 lb. |
| 2705 | 362 | 4.88 | 80 gal. | 172 | 7,000 lb. | 12,000 lb. | 18,000 lb. | 23,000 lb. | 15,392 lb. | 2,608 lb. |
| 2903 | 362 | 5.38 | 80 gal. | 190 | 7,500 lb. | 13,500 lb. | 20,500 lb. | 26,000 lb. | 16,430 lb. | 4,070 lb. |
| 3004 | 362 | 5.38 | 80 gal. | 200 | 7,500 lb. | 13,500 lb. | 20,500 lb. | 26,000 lb. | 16,830 lb. | 3,670 lb. |
| 3227 | 362 | 5.38 | 80 gal. | 200 | 7,500 lb. | 13,500 lb. | 20,500 lb. | 26,000 lb. | 16,784 lb. | 3,716 lb. |
| 3306 | 362 | 5.38 | 80 gal. | 208 | 7,500 lb. | 13,500 lb. | 20,500 lb. | 26,000 lb. | 17,664 lb. | 2,836 lb. |
| 3404 | 362 | 5.38 | 80 gal. | 220 | 7,500 lb. | 13,500 lb. | 20,500 lb. | 26,000 lb. | 17,870 lb. | 2,630 lb. |

Lengths, heights, widths and dry weights are approximate. Weight will vary based on optional equipment added to the above base weight.

GAWR: Gross Axle Weight Rating is the maximum permissible weight for an axle.

GVWR: Gross Vehicle Weight Rating is the maximum permissible weight for a fully loaded motor coach.

GCWR: Gross Combination Weight Rating is the value specified by the manufacturer of the vehicle as the maximum allowable loaded weight of this motor coach and any towed trailer or towed vehicle.

UVW: Unloaded Vehicle Weight is the weight of this motor coach as built at the factory with full fuel, engine oil and coolants. Does not include cargo, fresh water, propane gas or dealer-installed accessories.

NCC: Net Carrying Capacity is the maximum weight of all occupants, including the driver, personal belongings, food, fresh water, waste water, propane gas, tools, tongue weight of towed vehicle, dealer-installed accessories, etc., that can be carried by the motor coach.

**Specifications supplied by the chassis manufacturer.*

Bay Star Sport R-Values:

Roof R-Value = 16

Sidewall R-Value = 11

Floor R-Value = 11

BAY STAR SPORT



CHASSIS FEATURES

Ford® F-53 Chassis 18,000 lb. on 27' Floor Plans

Ford® F-53 Chassis 20,500 lb. on 29'-33' Floor Plans

Cruise Control

Tilt Steering Wheel

Stainless Steel Wheel Simulators



AIR CONDITIONING AND HEATING

13.5M Brisk® Central Air Conditioner

Dash Heater and Air Conditioner

Propane Gas Furnace with Ducted Heat

Propane Leak Detector

OPTIONS

15.0M Penguin™ Heat Pump Central Air Conditioner

Driver & Passenger Overhead Dash Fans

Two 13.5 Penguin Heat Pump A/C, 5.5 Onan Generator, 50 Amp Electrical Service with Energy Management System



APPLIANCES

Three-Burner Range Oven

Range Hood with Light and Fan

Microwave

Dometic® 6 Cf. Refrigerator with Wood Paneling Front

6 gal. Gas/Electric Water Heater with Direct Spark Ignition



AUDIO, VIDEO AND ACCESSORIES

LED TV in Living Area (TV sizes vary per floor plan)

AM/FM/CD Dash Radio with Harman/JBL 180 Watt Sound System

Color Rearview Monitor System with Audio

Winegard Digital TV Antenna

OPTIONS

28" LED TV in Bedroom

DVD Player with Coax Switcher

Satellite Dish Prep on Roof

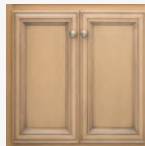

CABINETS AND FURNITURE

Empire Maple Mitered Designer Glazed Cabinet Doors

Concealed Hinges on Cabinet Doors

Residential-Style Full-Extension Ball Bearing Drawer Guides

Polished Solid Surface Countertop in Kitchen with Stainless Steel Sink

Solid Surface Countertops in Bathroom and Bedroom

Flexsteel® Deluxe Leather Furniture

Lifts on Bed Top

Smooth-Top Mattress

Brushed Nickel Hardware

OPTIONS

Astoria Maple Mitered Designer Glazed Cabinets

Sienna Maple Mitered Designer Glazed Cabinets

Combination Desk with Buffet Dinette Table, 2 Fixed & 2 Folding Chairs

Drop Down Bunk Bed Over Driver/Passenger Seats

Plush Pillow Top Mattress

Folding Cockpit Table

Off Door Side-Side Opening Hide-A-Bed Sofa

Off Door Side Fold & Tumble Sofa with Air Mattress

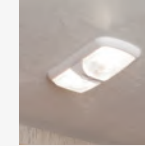

ELECTRICAL FEATURES

4.0 kW Cummins Onan® Generator with Remote Switch and Automatic Changeover

30 Amp Electrical Service with Flexible Cord and Automatic Transfer Switch

Two 12 Volt House Batteries

Manual Battery Disconnect Switch for House Battery

110 Volt Exterior Receptacle

12 Volt Auxiliary Receptacle on Dashboard

45 Amp Converter

Daytime Running Lights

Emergency Start Switch

Incandescent Ceiling Lights Throughout

Manually Operated Hold-To-Run Slideout Switch

Cable TV Connection

OPTIONS

1000 Watt Inverter Ran to TVs (Not Available with Option 6J655)

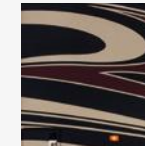

EXTERIOR FEATURES

Exterior Masterpiece® Full Painted Graphics with Clear Coat Finish

Dura Shield Protection on Front Cap

Automatic Step for Entrance Door

Convex Exterior Mirrors

Lit Exterior Storage Compartments Finished with Cargo Liner

Rear Hitch for Towing Car

Assist Handle at Entrance Door

Undercoating

Mud Flaps

OPTIONS

Convex Exterior Mirrors with Defrost and Remote Control

Hydraulic Leveling Jacks

Rear Ladder

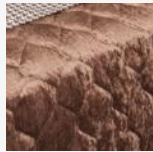

INTERIOR FEATURES

Vinyl Ceiling Panels

Pleated Window Shades

Decorative Wall Art

Mini Blinds in Kitchen and Bathroom Windows

Vinyl Floor in Kitchen, Living Area and Bathroom

Carpeting in Bedroom and on Slide-Out Floors

Interior Assist Handle at Main Entrance Door

Quilted Bedspread, Bed Scarf & Accent Pillows

Inlaid Six Panel Design Interior Passenger Doors

Auto Motion Power Shade at Windshield & Manual Shades at Driver & Passenger Side Windows

Dash Panel Color Coordinated ABS

10 Bc Fire Extinguisher, Smoke Detector and Carbon Monoxide Detector



PLUMBING AND BATH FEATURES

Demand Water System

Sewage Holding Tank Rinse

Water Heater Bypass System

Dometic® 310 China Bowl Stool

ABS Shower Surround with Shower Door

Systems Monitor Panel



CONSTRUCTION FEATURES

BriteTEK™ Roof with Walkable Decking

Gel Coated Fiberglass Exterior Sidewalls, Front & Rear Caps

Aluminum-Frame Sidewalls & Roof Construction on 16" Center

5/8" Foam Insulation Laminated in Sidewalls & Ceiling

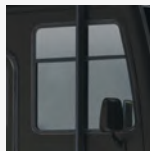

WINDOWS, AWNINGS AND VENTS

One-Piece Tinted Windshield

Frameless Single Pane Tinted Safety-Glass Windows

Power Vent in Bathroom

Skylight Above Shower

Dometic® 9100 Power Side Awning

OPTIONS

Slideout Covers

Frameless Double-Pane Tinted Safety Glass Windows

Rear Window in Bedroom

Power Vent in Kitchen

Bunk Windows*

**Check With Dealership On Floor Plan Availability*





BAY STAR

WELCOME TO THE GOOD LIFE

Stunning Full-Paint Masterpiece™ Finish

Refreshed interior décor with solid surfaces throughout

Custom-built Comfort Dinette available with select floor plans

Flexsteel® Ultralux leather sofa and captain's chairs



WHEN YOU KNOW THE DIFFERENCE SM



Angora Interior Décor and Empire Glazed Maple Cabinetry - Floor Plan 3403



YOUR WANTS AND NEEDS. TOGETHER.

Loaded with useful features and extra amenities, the 2016 Bay Star represents one incredible package. Up front, an all-new 4-speaker JBL® premium cockpit audio system has been custom-tuned for Bay Star. Inside, you'll find a stylish new décor, attractive vinyl tile flooring and an inviting 84" Flexsteel® Ultralux leather sofa.*

Equal parts style and substance, the galley is brought to life by a spacious refrigerator and pantry, redesigned cabinet door and drawer hardware, solid-surface countertops and a standard kitchen window.

**84" sofa included with floor plan 3403*



Optional Vinyl Tile Flooring



Empire Glazed Maple Cabinetry with New Door and Drawer Hardware

INNOVATION COMES STANDARD

Introducing the all-new Comfort Dinette,* expertly-crafted by Newmar artisans to resemble the Euro-booth dinettes found in many of today's finest homes. Designed to be both functional and accommodating, the Comfort Dinette takes multipurpose design to a whole new level, transforming into a guest bed in seconds.

**Comfort Dinette not available with floor plans 3004 and 3227*



New Tile Backsplash



DESIGNED WITH YOU IN MIND

Bay Star's master bedroom is crafted to make even the busiest travelers feel right at home. A full queen bed and leather-wrapped headboard is decorated to match the intricate styling found in the living area, while the new Angora décor adds a touch of elegance you'll appreciate for years to come.

Accommodations include an expansive wardrobe that contains a generous amount of storage drawers and double-facing mirrors. In between, you will find a Sony® LED TV with DVD player capable of bringing your favorite movies and TV shows to life with the press of a button. Finally, a solid-surface nightstand acts as the perfect complement to a truly welcoming space.

SONY®



Double-Facing Wardrobe with Sony® LED TV

THE PERFECT WAY TO START YOUR DAY

It's easy to begin every journey refreshed and ready when your coach is a 2016 Bay Star. A lovely master bathroom comes complete with a solid-surface vanity, large shower and plenty of linen storage. Just down the hall, you'll find a convenient half-bath* adorned with a stainless steel sink and tasteful one-lever faucet.

**Half bath included with floor plan 3403*

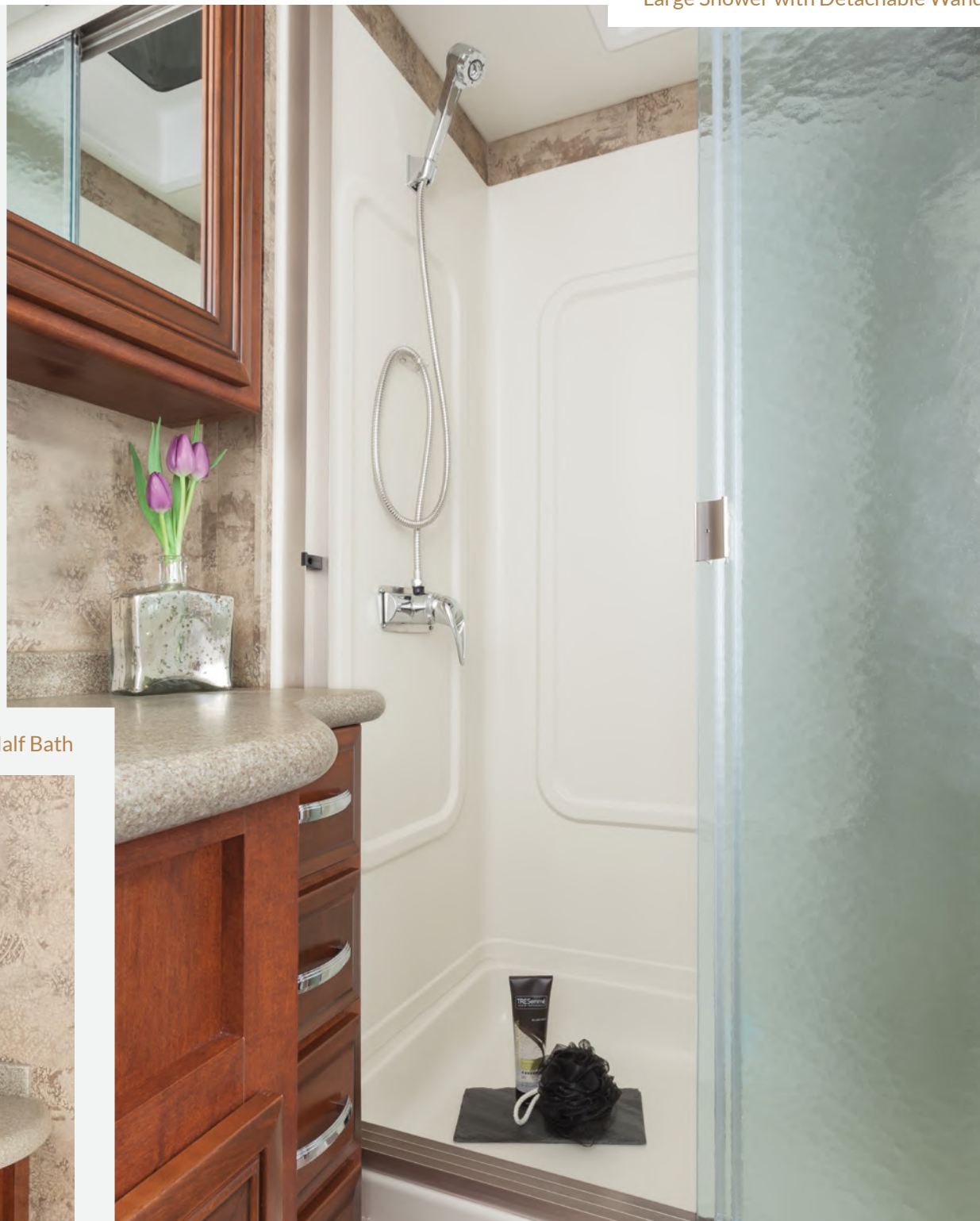

New One-Lever Faucet in Half Bath

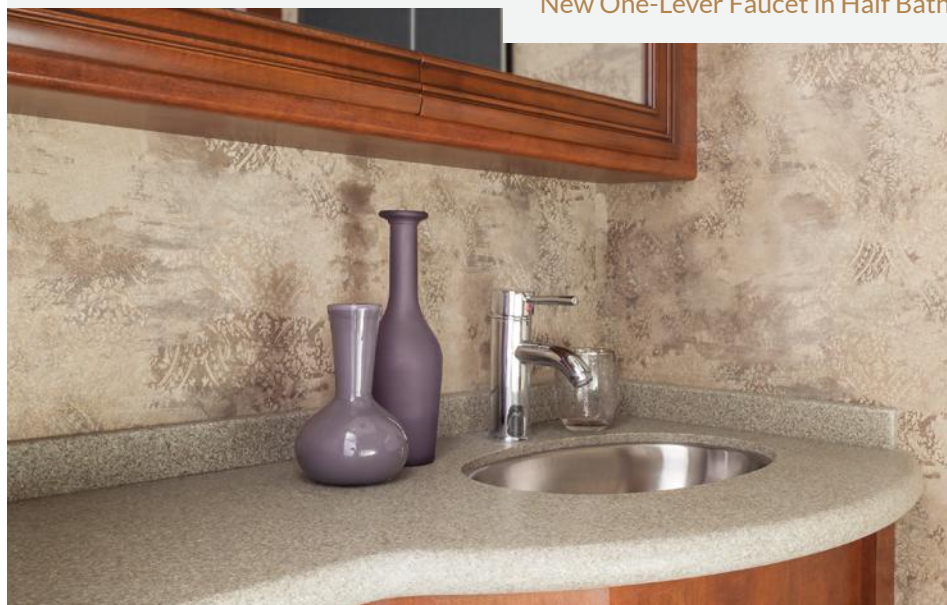

EXTERIOR DÉCOR



MARKET EXTERIOR

INTERIOR DÉCOR



ANGORA INTERIOR

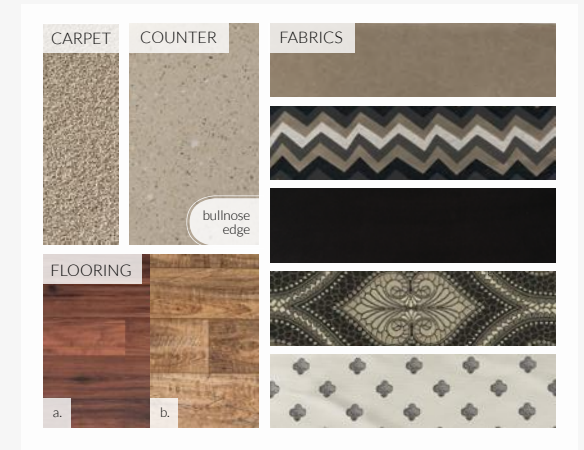

POTOMAC INTERIOR

WOOD OPTIONS



CITYSCAPE EXTERIOR



ASTORIA GLAZED
MAPLE



SIENNA GLAZED
MAPLE



EMPIRE GLAZED
MAPLE

*Flooring option a. pairs with Empire Glazed Maple wood and flooring option b. pairs with Astoria Glazed Maple or Sienna Glazed Maple woods

OPTIONAL FLOORING



ANGORA OPTIONAL FLOORING



POTOMAC OPTIONAL FLOORING

FLOOR PLANS

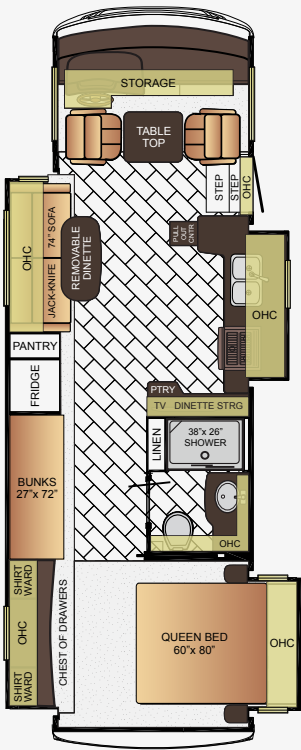

3004

| | |
|---------------------|------------|
| App. Overall Length | 30'11" |
| Width | 101.5" |
| App. Overall Height | 12'8" |
| Interior Width | 95.5" |
| Interior Height | 80" |
| Grey Tank | 60 gal. |
| Sewage Tank | 40 gal. |
| Water Tank | 75 gal. |
| Propane Tank | 25 gal. |
| Furnace | 40,000 btu |

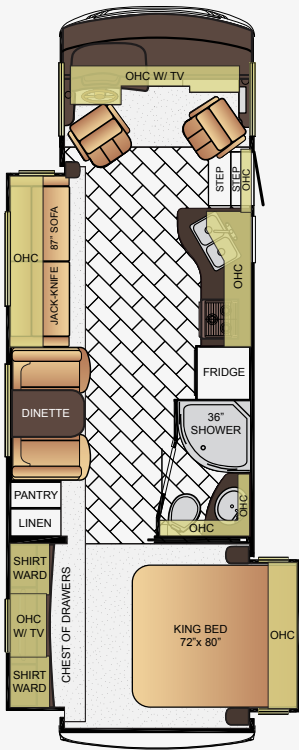

3124

| | |
|---------------------|------------|
| App. Overall Length | 31'11" |
| Width | 101.5" |
| App. Overall Height | 12'8" |
| Interior Width | 95.5" |
| Interior Height | 80" |
| Grey Tank | 60 gal. |
| Sewage Tank | 40 gal. |
| Water Tank | 75 gal. |
| Propane Tank | 25 gal. |
| Furnace | 40,000 btu |

BAY STAR

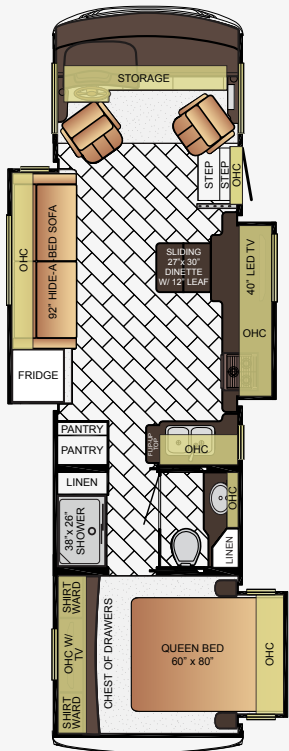

3227

| | |
|---------------------|------------|
| App. Overall Length | 32'11" |
| Width | 101.5" |
| App. Overall Height | 12'8" |
| Interior Width | 95.5" |
| Interior Height | 80" |
| Grey Tank | 60 gal. |
| Sewage Tank | 40 gal. |
| Water Tank | 75 gal. |
| Propane Tank | 25 gal. |
| Furnace | 40,000 btu |

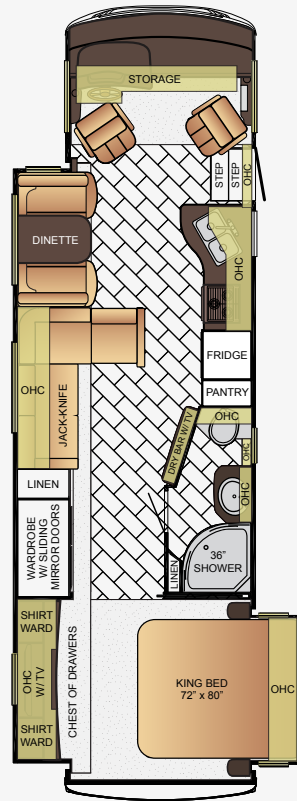

3401

| | |
|---------------------|------------|
| App. Overall Length | 34'11" |
| Width | 101.5" |
| App. Overall Height | 12'8" |
| Interior Width | 95.5" |
| Interior Height | 80" |
| Grey Tank | 60 gal. |
| Sewage Tank | 40 gal. |
| Water Tank | 75 gal. |
| Propane Tank | 25 gal. |
| Furnace | 40,000 btu |

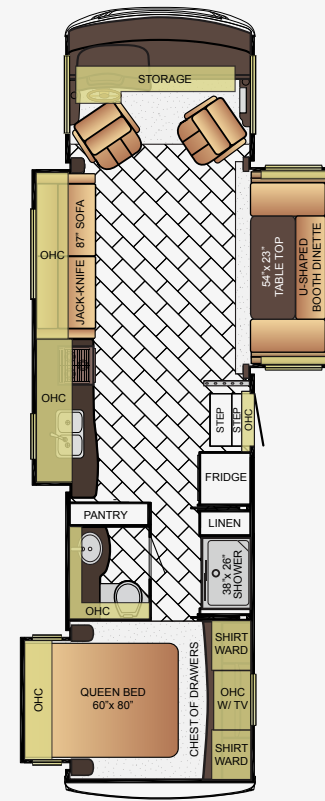

3402

| | |
|---------------------|------------|
| App. Overall Length | 34'11" |
| Width | 101.5" |
| App. Overall Height | 12'8" |
| Interior Width | 95.5" |
| Interior Height | 80" |
| Grey Tank | 60 gal. |
| Sewage Tank | 40 gal. |
| Water Tank | 75 gal. |
| Propane Tank | 25 gal. |
| Furnace | 40,000 btu |

FLOOR PLANS

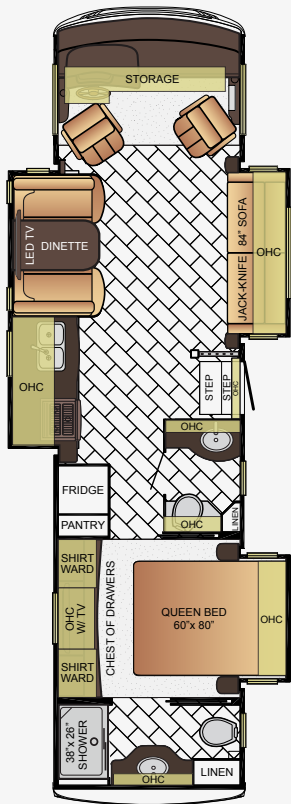

3403

| | |
|---------------------|------------|
| App. Overall Length | 34'11" |
| Width | 101.5" |
| App. Overall Height | 12'8" |
| Interior Width | 95.5" |
| Interior Height | 80" |
| Grey Tank | 60 gal. |
| Sewage Tank | 86 gal. |
| Water Tank | 75 gal. |
| Propane Tank | 25 gal. |
| Furnace | 40,000 btu |

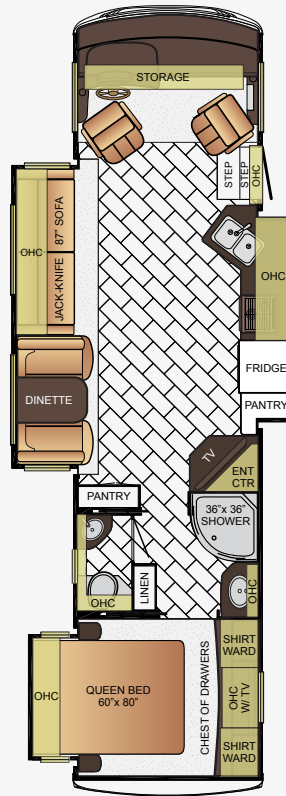

3404

| | |
|---------------------|------------|
| App. Overall Length | 34'11" |
| Width | 101.5" |
| App. Overall Height | 12'8" |
| Interior Width | 95.5" |
| Interior Height | 80" |
| Grey Tank | 60 gal. |
| Sewage Tank | 40 gal. |
| Water Tank | 75 gal. |
| Propane Tank | 25 gal. |
| Furnace | 40,000 btu |

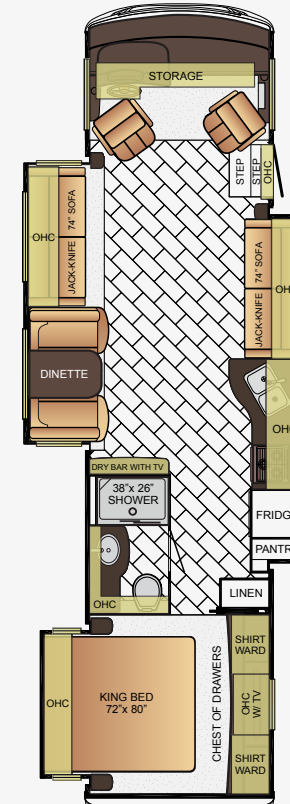

3518

| | |
|---------------------|------------|
| App. Overall Length | 35'11" |
| Width | 101.5" |
| App. Overall Height | 12'8" |
| Interior Width | 95.5" |
| Interior Height | 80" |
| Grey Tank | 60 gal. |
| Sewage Tank | 40 gal. |
| Water Tank | 75 gal. |
| Propane Tank | 25 gal. |
| Furnace | 40,000 btu |

BAY STAR CONSTRUCTION & CHASSIS SPECIFICATIONS

Like a fine home, the 2016 Bay Star gas motor coach is framed 16 inches on center, allowing the best placement of outlets, switches and other components. Newmar uses only Sikaflex® elastic adhesive throughout Bay Star's construction – one of the strongest bonding agents available. It seals against air and water

and helps dampen sound and vibration. Electrical wiring holes in Bay Star's aluminum frame are ringed with plastic grommets to protect wires from chafing. And Newmar's Total Comfort™ Central Air is two separate, fully ducted systems that distribute cool air and remove warm air.

| Floor Plan | Engine HP | Axle Ratio | Fuel Cap. | Wheel Base | Front GAWR* | Rear GAWR* | GVWR* | GCWR* | App. UVW | App. NCC |
|------------|-----------|------------|-----------|------------|-------------|------------|------------|------------|------------|-----------|
| 3004 | 362 | 5.38 | 80 gal. | 200 | 8,000 lb. | 15,000 lb. | 22,000 lb. | 26,000 lb. | 17,756 lb. | 4,744 lb. |
| 3124 | 362 | 5.38 | 80 gal. | 200 | 8,000 lb. | 15,000 lb. | 22,000 lb. | 26,000 lb. | 18,030 lb. | 3,970 lb. |
| 3227 | 362 | 5.38 | 80 gal. | 200 | 8,000 lb. | 15,000 lb. | 22,000 lb. | 26,000 lb. | 17,886 lb. | 4,114 lb. |
| 3401 | 362 | 5.38 | 80 gal. | 220 | 8,000 lb. | 15,000 lb. | 22,000 lb. | 26,000 lb. | 19,123 lb. | 2,877 lb. |
| 3402 | 362 | 5.38 | 80 gal. | 220 | 8,000 lb. | 15,000 lb. | 22,000 lb. | 26,000 lb. | 19,044 lb. | 2,956 lb. |
| 3403 | 362 | 5.38 | 80 gal. | 216 | 8,000 lb. | 15,000 lb. | 22,000 lb. | 26,000 lb. | 19,194 lb. | 2,806 lb. |
| 3404 | 362 | 5.38 | 80 gal. | 220 | 8,000 lb. | 15,000 lb. | 22,000 lb. | 26,000 lb. | 18,994 lb. | 3,006 lb. |
| 3518 | 362 | 5.38 | 80 gal. | 220 | 8,000 lb. | 15,000 lb. | 22,000 lb. | 26,000 lb. | 19,215 lb. | 2,785 lb. |

Lengths, heights, widths and dry weights are approximate. Weight will vary based on optional equipment added to the above base weight.

GAWR: Gross Axle Weight Rating is the maximum permissible weight for an axle.

GVWR: Gross Vehicle Weight Rating is the maximum permissible weight for a fully loaded motor coach.

GCWR: Gross Combination Weight Rating is the value specified by the manufacturer of the vehicle as the maximum allowable loaded weight of this motor coach and any towed trailer or towed vehicle.

UVW: Unloaded Vehicle Weight is the weight of this motor coach as built at the factory with full fuel, engine oil and coolants. Does not include cargo, fresh water, propane gas or dealer-installed accessories.

NCC: Net Carrying Capacity is the maximum weight of all occupants, including the driver, personal belongings, food, fresh water, waste water, propane gas, tools, tongue weight of towed vehicle, dealer-installed accessories, etc., that can be carried by the motor coach.

**Specifications supplied by the chassis manufacturer.*

Bay Star R-Values:

Roof R-Value = 16

Sidewall R-Value = 11

Floor R-Value = 11

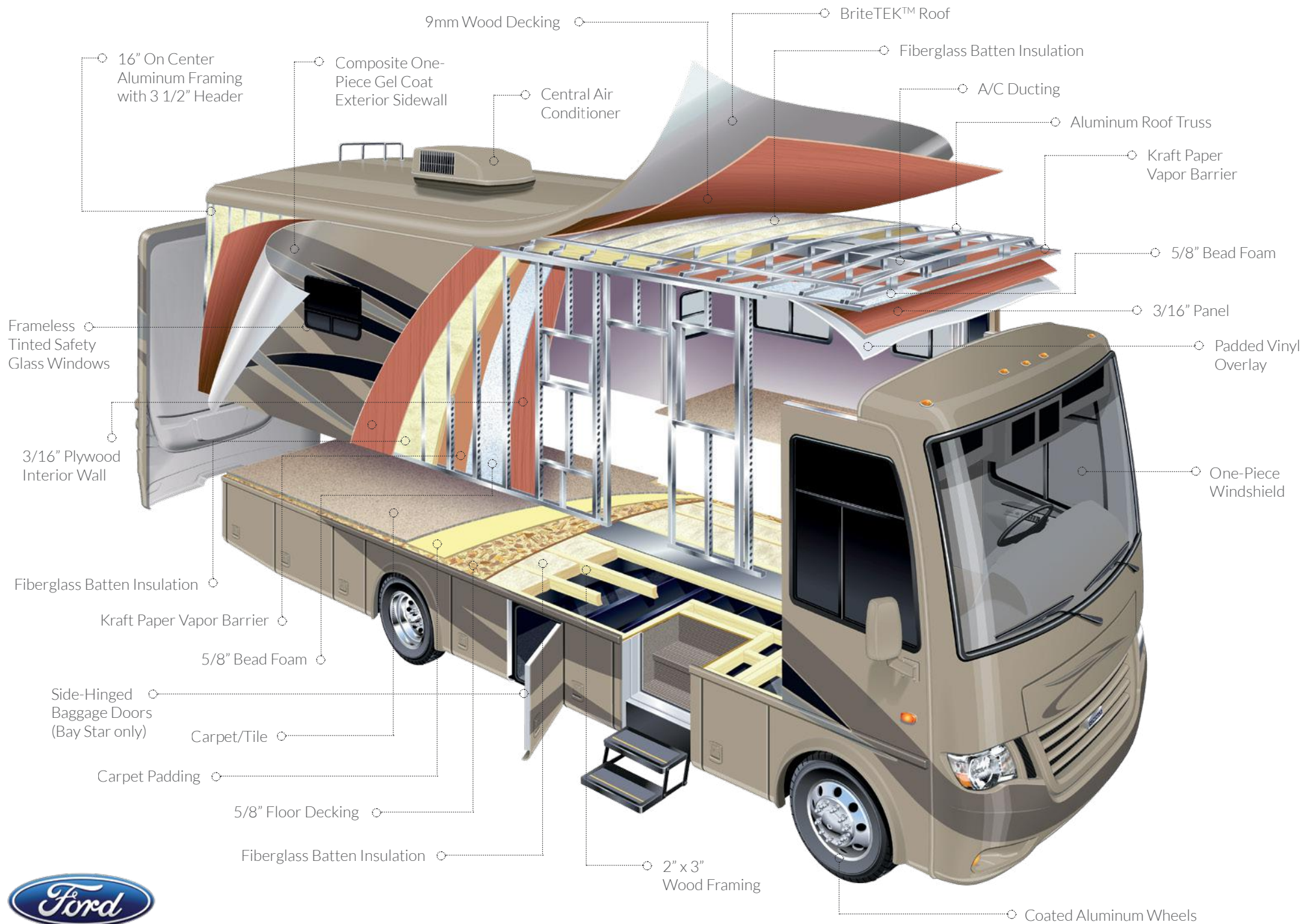

BAY STAR



CHASSIS FEATURES

Ford® F-53 Chassis 22,000 lb.

Cruise Control

Tilt Steering Wheel

Aluminum Wheels



AIR CONDITIONING AND HEATING

13.5M Penguin Central Air Conditioner

Dash Heater and Air Conditioner

Driver & Passenger Overhead Dash Fans

Propane Gas Furnace with Ducted Heat

Propane Leak Detector

OPTIONS

15.0M Penguin Heat Pump Air Conditioner

Two 13.5 Penguin Heat Pump A/C, 5.5 Onan Generator, 50 Amp Electrical Service with Energy Management System

Auxiliary Heater in Bedroom



APPLIANCES

Three-Burner Range Oven

Bi-Fold Range Cover

30" Over the Range Microwave

Norcold® 8 Cf. Refrigerator with Black Panel Front

6 gal. Gas/Electric Water Heater with Electronic Ignition

OPTIONS

Frigidaire® 10 Cf. Refrigerator with Dedicated 1000 Watt Pure Sine Inverter & 2 Extra Batteries

Icemaker Added to Norcold Refrigerator

30" Convection Microwave with 3 Burner Cooktop



AUDIO, VIDEO AND ACCESSORIES

Sony® LED TV & DVD Player in Living and Bedroom Areas (TV sizes vary per floor plan)

AM/FM/CD Dash Radio with Harman/JBL 180 Watt Sound System

Rearview Color Monitor System with Audio

Winegard Digital Crank Up TV Antenna

Satellite Dish Prep on Roof

OPTIONS

32" LED TV in Front Overhead

High Definition Component Wiring with Blu-ray DVD Player

Side View Cameras Displayed Onto Rearview Monitor Screen

Sirius® Satellite Radio Capability with Antenna (Does Not Include Monthly Subscription)

Sony® Surround Sound with Sub-Woofer

Winegard Automatic Open Face Satellite Dish



CABINETS AND FURNITURE

Empire Maple Mitered Designer Glazed Cabinet Doors

Concealed Hinges on Cabinet Doors

Drawers with Full-Extension Guides

Polished Solid-Surface Countertop in Kitchen with Stainless Steel Sink

Solid-Surface Countertops in Bathroom and Bedroom

Flexsteel® Ultralux Leather Sofa and Front Seats

Lifts on Bed Top

Smooth-Top Mattress

Passenger Seat Work Station

Pullout Pantry Shelves*

OPTIONS

Astoria Maple Mitered Designer Glazed Cabinets

Sienna Maple Mitered Designer Glazed Cabinets

Combination Desk with Buffet Dinette Table, 2 Fixed & 2 Folding Chairs

Combination Desk/Dinette with Freestanding Hidden Leaf Table

Freestanding Hidden Leaf Dinette Table, 2 Fixed & 2 Folding Chairs

Drop Down Bunk Bed Over Driver/Passenger Seats with 32" TV in Front Overhead

Plush Pillow Top Mattress

Folding Cockpit Table

Hide-A-Bed Sofa

Off Door Slide-Out Opening Hide-A-Bed Sofa

Off Door Slide-Out & Tumble Sofa with Air Mattress

Six Way Power for Driver Seat

Radius Fireplace

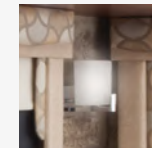

ELECTRICAL FEATURES

4.0 kW Cummins Onan® Generator with Remote Switch and Automatic Changeover

30 Amp Electrical Service with Flexible Cord and Automatic Transfer Switch

Two 12 Volt House Batteries

Manual Battery Disconnect Switch for House Battery

12 Volt Auxiliary Receptacle on Dashboard

45 Amp Converter

Daytime Running Lights

Emergency Start Switch

LED Ceiling Lights

FEATURES & OPTIONS

Manually Operated Hold-To-Run Slideout Switch

Cable TV Connection

5 Watt Solar Panel to Charge Chassis Battery

Lights in Wardrobes

USB Charger at Passenger Seat Area

OPTIONS

1000 Watt Inverter Ran to TVs (Not Available with Option 6J655)

50 Amp Electrical Service with Flexible Cord and Automatic Transfer

Solar Prep Wire from Roof to House Battery Compartment



EXTERIOR FEATURES

Exterior Masterpiece® Full Painted Graphics with Clear Coat Finish

Dura Shield Protection on Front Cap

Lit Exterior Storage Compartments with Cargo Liner

Automatic Step for Entrance Door

Convex Exterior Mirrors with Defrost

Rear Hitch for Towing Car

Assist Handle at Entrance Door

Undercoating

Mud Flaps

Hydraulic Leveling Jacks

OPTIONS

Convex Exterior Mirrors with Defrost and Remote Control

Rear Ladder



INTERIOR FEATURES

Vinyl Ceiling Panels

Day/Night Pleated Window Shades

Decorative Wall Art

Mini Blinds on Kitchen and Bathroom Windows

Vinyl Floor in Kitchen, Living Area and Bathroom

Carpeting in Bedroom and on Slide-Out Floors

Interior Assist Handle at Main Entrance Door

Quilted Bedspread, Bed Scarf & Accent Pillows

Inlaid Six Panel Design Interior Passenger Doors

Auto Motion Power Shade at Windshield & Manual Shades at Driver & Passenger Side Windows

Dash Panel Color Coordinated ABS

10 Bc Fire Extinguisher, Smoke Detector and Carbon Monoxide Detector

Shoe Storage Located in Entrance Door Step Compartment

OPTIONS

Auto Motion Manual Double Roller Shades on Windows Behind Driver/Passenger Area

Vinyl Tile Floor in Place of Vinyl Floor

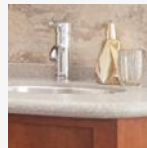

PLUMBING AND BATH FEATURES

Demand Water System

Sewage Holding-Tank Rinse

Water Heater Bypass System

Dometic® 310 China Bowl Stool

ABS Shower Surround with Shower Door

Systems Monitor Panel

Exterior Shower Located on Off-Door Side

OPTIONS

110 Volt Heat Pads for Holding Tanks



CONSTRUCTION FEATURES

BriteTEK™ Roof with Walkable Decking

Gel Coated Fiberglass Exterior Sidewalls, Front & Rear Caps

Aluminum-Frame Sidewalls & Roof Construction on 16" Center

5/8" Foam Insulation Laminated in Sidewalls & Ceiling

OPTIONS

Polar Pak R19 Batten Insulation in Roof



WINDOWS, AWNINGS AND VENTS

One Piece Tinted Windshield

Frameless Single Pane Tinted Safety-Glass Windows

Power Vent in Kitchen and Bathroom

Skylight Above Shower

Dometic® Weather Pro Power Side Awning with Aluminum Weather Shield

Slide-Out Covers

OPTIONS

Frameless Double-Pane Tinted Safety Glass Windows

Rear Window in Bedroom

Fantastic Vent with Rain Sensor in Kitchen & Bathroom

**Check With Dealership On Floor Plan Availability*



OUR PARTNERS

Where the Finest Names in Quality and Performance are Along for the Ride

To ensure that you experience only the best in comfort, control and unsurpassed convenience in our incomparable family of Luxury Coaches, Newmar partners with the most prestigious names in mobile lifestyle, entertainment and technology. These brands

are leaders in their fields and legends in providing customers with new, unsurpassed levels of quality and reliability. Best-in-class performance from names you can trust. At Newmar, that's our difference. And our promise.



THE MILLER WAY

*Industry-Leading Quality,
From Our Family to Yours*

For the Miller family, RVs are what we build because RVing is what we love. To us, the RV lifestyle is more than our business – it's our passion. Our customers choose Newmar time and time again because they trust in us, our products and our people.

I myself am proud to own a Dutch Star designed, assembled and backed by artisans, engineers and service specialists who represent the best our industry has to offer. Men and women who have spent an average of 13 years as members of the Newmar family. Without them, The Newmar Difference simply wouldn't exist.

Matt Miller
Newmar President, lifelong motor coach enthusiast

Bay Star S P O R T AND *Bay Star*

NEWMAR EXPRESS LIMITED WARRANTY

Every Bay Star Sport and Bay Star gas motor coach is backed by Newmar's one-year limited warranty/unlimited miles. Ask your Newmar dealer for details.

LIMITED FIVE-YEAR STRUCTURAL WARRANTY

If any part of your Newmar recreational vehicle superstructure (which is the steel/aluminum structure of the sidewall, roof or frame) fails to perform properly within five years from the date of purchase because of faulty workmanship or material supplied by Newmar, it will be repaired by Newmar, free of charge. This structural warranty is available only to the original purchaser and is non-transferable.

Some features in our literature are optional. Colors and finishes are photographic representations. The actual materials may look different. Prices, specifications and floor plans are subject to change at Newmar's discretion, without prior notice or obligation. Please see your dealer for actual samples and specifications.



WHEN YOU KNOW THE DIFFERENCE SM



NEWMAR CORPORATION | 355 N DELAWARE ST | PO BOX 30 | NAPPANEE IN 46550-0030 | 574-773-7791 Fax 574-773-2895
www.newmarcorp.com